

Orchid



Orchids are my favourite flowers so when I saw this orchid punch I knew it was coming home with me! This punch is designed to be used to construct a three-dimensional orchid, but several different flower types are available as punches. The orchids made in this project can be used to create mini plants or as super embellishments for your cards.



You will need

- Craft punches: orchid, oval and small circle 1.6cm (5/8in)
- Craft knife, cutting mat, ruler and scissors
- Ball-tipped stylus
- Clear adhesive and tweezers
- Artist's chalks: pink, green and yellow
- Fine pink felt-tip pen
- Double-sided tape
- 16cm (6 1/4in) of high-gauge wire and 12cm (4 3/4in) of low-gauge wire
- Mini flowerpot and air-drying clay
- Modelling lichen
- Sheets of card: white and green



1. Use the orchid punch twice (see inset) and gather together these pieces.

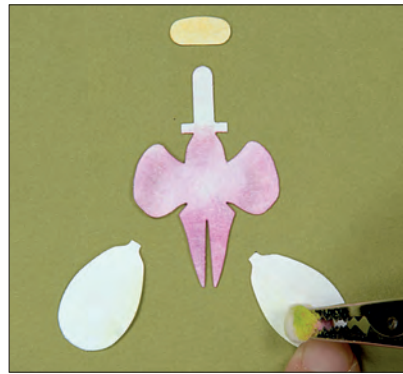

2. Chalk the stamen yellow, the lower petals slightly green and the inner petals pink.

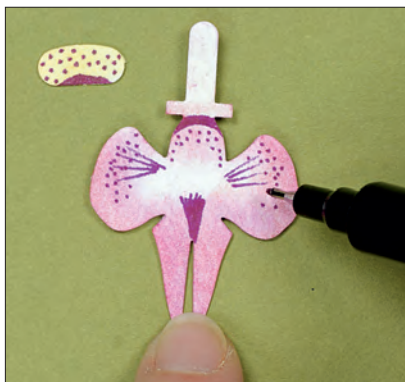

3. Use a fine pink felt-tip pen to detail the inner petals and the stamen as shown.

4. Use your fingers to fold the inner petals up as shown. Add a touch of chalk and pen to detail the parts that curl over, then add a dot of clear adhesive to the tabs (see inset).

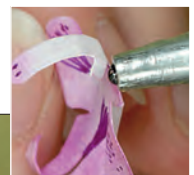



5. Close the outer petals to glue them to the tabs, then fold the stamen, add a dab of clear adhesive and use tweezers to place it in the centre.

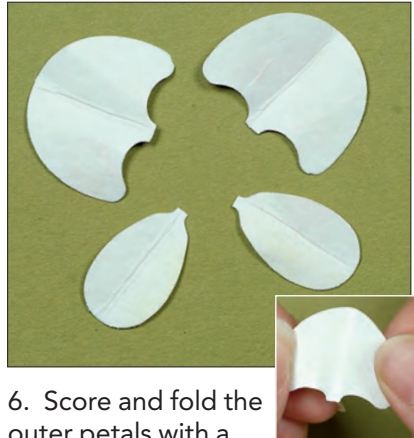

6. Score and fold the outer petals with a ruler and ball-tipped stylus, then use your fingers (see inset) to give each petal a slight curve.

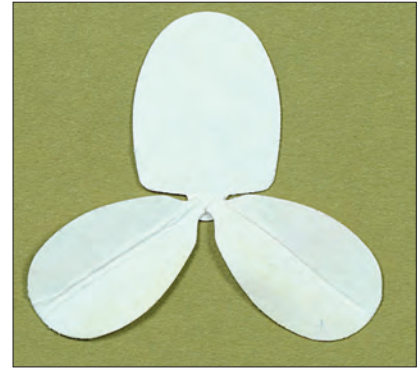

7. Add a dab of glue to the tab of the central petal and place the shaped lower petals on the tab.



8. Add glue to the tabs of the shaped upper petals and attach them at the same point.



9. Glue the inside of the orchid to the outer petals, then make a second orchid in the same way.

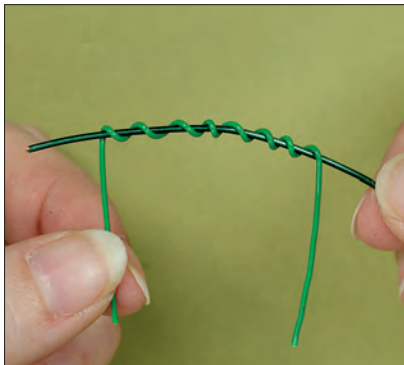

10. Wrap the high-gauge (softer) wire around the low-gauge (firmer) wire, leaving approximately 3cm (1¼in) at both ends unwrapped.



11. Put a strip of double-sided tape on the edge of the white card, then use the circle punch to punch through twice.

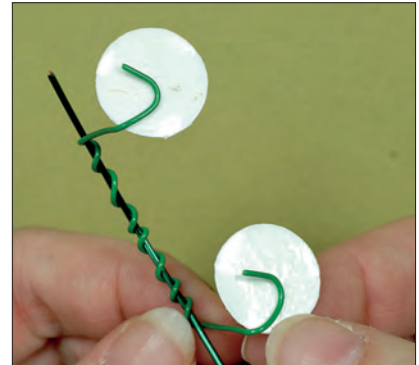

12. Bend both loose ends of the high-gauge wire into curves, then remove the backing from the white circles and place them on the wire.

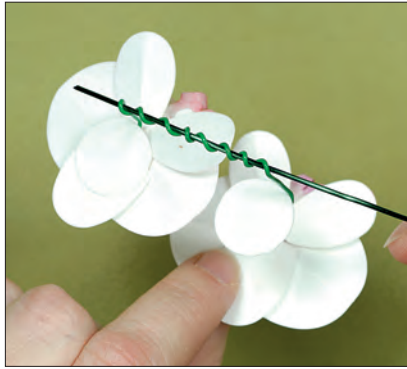

13. Stick the backs of the orchid flowers to the sticky circles.



14. Fill a mini flowerpot with air-drying clay and push the wire flower stem into the clay.



15. Punch three ovals from green card with the oval punch, then fold them in half and trim either side of the fold lines to make leaf shapes.

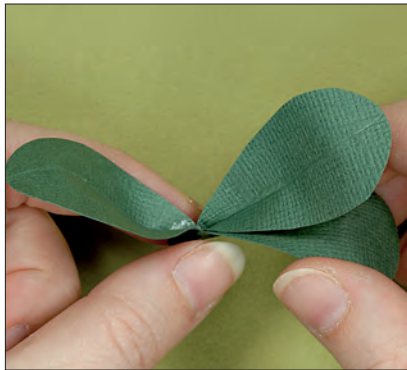

16. Use your fingers to shape the leaves and glue them together as shown.



17. Push the leaves into the air-drying clay.

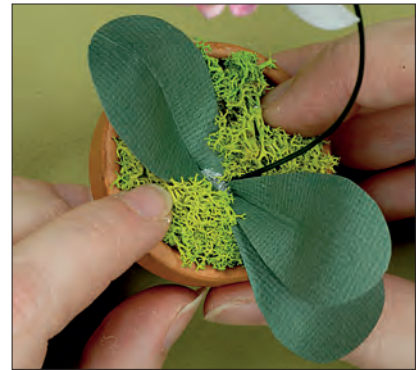

18. Cover the air-drying clay with modelling lichen to finish.

Opposite

This orchid will flower continually, needs no care or attention and certainly no watering!

